

**BEGA****50 264.2**

Wall luminaire for indoor use



Project · Reference number



Date

## Product data sheet

### Application

Shielded wall luminaire · indoor luminaire made of hand-blown opal glass, satin matt with metal shield, for many lighting tasks.  
The light emits upwards and downwards.

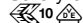
### Product description

Metal housing, finish colour white  
Hand-blown opal glass, satin matt  
Metal shield, stainless steel finish  
2 elongated fixing holes  
Width 4.5 mm · 185 mm spacing  
1 cable entry for through-wiring  
for mains cable  
Connecting terminals 2.5<sup>□</sup>  
Earth conductor connection  
LED-Module for mains voltage  
220-230 V ~ 50/60 Hz  
BEGA Thermal Switch®  
Temporary thermal shutdown to protect temperature-sensitive components  
Safety class I  
 – Safety mark  
 – Conformity mark  
Weight: 1.2 kg  
This product contains light sources of energy efficiency class(es) F

### Lighting technology

Luminaire data for the DIALux lighting design program for outdoor lighting, street lighting and indoor lighting, as well as luminaire data in EULUMDAT and IES format are available on the BEGA website at [www.bega.com](http://www.bega.com).

### Lamp

Luminaire connected wattage 10 W  
Rated temperature  $t_a = 25\text{ °C}$   
Ambient temperature  $t_{a\text{ max}} = 35\text{ °C}$

### 50 264.2 K3

Module designation LED-0607/930  
Colour temperature 3000 K  
Colour rendering index  $R_a > 90$   
Module luminous flux 940 lm  
Luminaire luminous flux 495 lm  
Luminaire luminous efficiency 49,5 lm/W

### Service life · Ambient temperature

Rated temperature  $t_a = 25\text{ °C}$   
LED module: 82,000 h (L 80 B 50)

Ambient temperature max.  $t_a = 35\text{ °C}$  (100 %)  
LED module: 78,000 h (L 80 B 50)

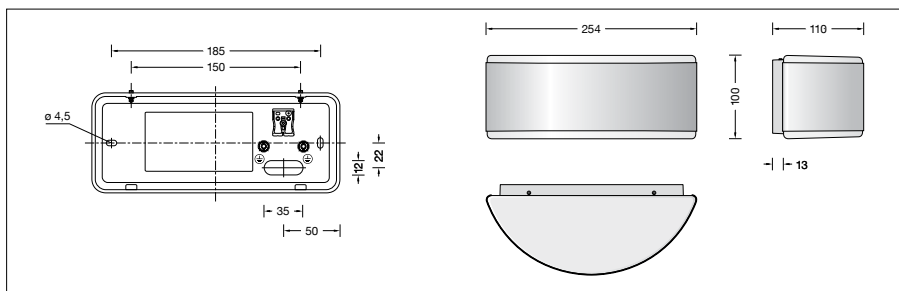

### Article No. 50 264.2

Finish options

- White
- Stainless steel

Code number **.1**Code number **.2**