



Ledinaire floodlights gen3

BVP164 LED11/830 PSU 10W SWB MDU CE

- - - 830 warm white - - - Symmetrical

This Ledinaire floodlights range contains a selection of popular off-the-shelf LED luminaires that comes with the Philips high quality levels at a competitive price. Reliable, energy-efficient and affordable – just what you need.

Product data

| General Information | | | |
|------------------------------------|------------------------------------|------------------------------------------|--------------------------|
| Lamp family code | - | Optical cover/lens type | Glass |
| Light source replaceable | No | Luminaire light beam spread | 110° x 110° |
| Number of gear units | 1 unit | Optic type outdoor | Symmetrical wide beam |
| Driver included | Yes | Operating and Electrical | |
| Light source engine type | LED | Input Voltage | 220 to 240 V |
| Service tag | No | Line Frequency | 50 or 60 Hz |
| Lighting Technology | LED | Input Frequency | 50 or 60 Hz |
| Embedded control | Movement and light sensor (On/Off) | Initial CLO power consumption | - W |
| Light Technical | | Average CLO power consumption | 10 W |
| Upward light output ratio | 0 | Power Consumption | 10 W |
| Luminous Flux | 1,100 lumen | End CLO power consumption | - W |
| Standard tilt angle posttop | - | Inrush current | 0.78 A |
| Standard tilt angle side entry | - | Inrush time | 0.00648 ms |
| Correlated Color Temperature (Nom) | 3000 K | Power Factor (Fraction) | 0.7 |
| Luminous Efficacy (rated) (Nom) | 110 lm/W | Connection | Flying leads/wires |
| Color rendering index (CRI) | >80 | Cable | Cable 1.0 m without plug |
| Light source color | 830 warm white | Number of products on MCB of 16 A type B | 210 |

Ledinaire floodlights gen3

| | |
|----------------------------------------|----------------------------------------------|
| Temperature | |
| Ambient temperature range | -20 to +40 °C |
| Controls and Dimming | |
| Dimmable | No |
| Driver/power unit/transformer | - |
| Control interface | - |
| Constant light output | No |
| Mechanical and Housing | |
| Housing Material | Aluminum die cast |
| Reflector material | Polycarbonate |
| Optic material | Glass |
| Optical cover/lens material | Tempered glass |
| Fixation material | Steel |
| Housing Color | Gray |
| Mounting device | Mounting bracket adjustable |
| Optical cover/lens shape | Flat |
| Optical cover/lens finish | Clear |
| Overall length | 79 mm |
| Overall width | 155 mm |
| Overall height | 52 mm |
| Effective projected area | 0.005 m² |
| Dimensions (Height x Width x Depth) | NaN x NaN x NaN mm |
| Approval and Application | |
| Ingress protection code | IP65 [Dust penetration-protected, jet-proof] |
| Mech. impact protection code | IK07 [2 J reinforced] |
| Surge Protection (Common/Differential) | 2/2 kV |
| Sustainability rating | - |
| Protection class IEC | Safety class I |
| Flammability mark | - |
| CE mark | Yes |
| ENEC mark | - |
| Warranty period | 3 years |

| | |
|---------------------------------------------------------|------------------------------------------------|
| Photobiological risk | Photobiological risk group 1 @200mm to EN62778 |
| Photobiological risk specification | 0.2 m |
| EU RoHS compliant | Yes |
| Initial Performance (IEC Compliant) | |
| Luminous flux tolerance | +/-10% |
| Init. Corr. Color Temperature | 3000 K |
| Initial chromaticity | (0.440, 0.403) SDCM <5 |
| Power consumption tolerance | +/-10% |
| Init. Color Rendering Index Tolerance | +/-2 |
| Over Time Performance (IEC Compliant) | |
| Control gear failure rate at median useful life 50000 h | 5 % |
| Lumen maintenance at median useful life* 50000 h | 80 |
| Application Conditions | |
| Performance ambient temperature Tq | 25 °C |
| Maximum dim level | Not applicable |
| Product Data | |
| Full product code | 871951453482799 |
| Order product name | BVP164 LED11/830 PSU 10W SWB MDU CE |
| Order code | 911401883683 |
| Numerator - Quantity Per Pack | 1 |
| Numerator - Packs per outer box | 24 |
| Material number (12NC) | 911401883683 |
| Full product name | BVP164 LED11/830 PSU 10W SWB MDU CE |
| EAN/UPC - Case | 8719514534926 |



Dimensional drawing

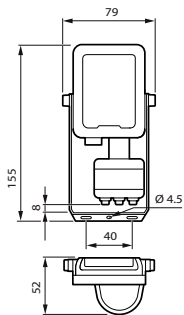

Ledinaire floodlights gen3

