

AIN LED1X550 D944 T830 • 1025073

Product:	Ain LED1x550 D944 T830
Order code:	1025073
Family:	Ain LED
Product group:	"Downlight" tipo šviestuvai

GENERAL DATA

Description:	Recessed mounted LED spotlight Light distribution type: direct Optical system: lens, 40°, tilting angle $\pm 30^\circ$ Housing: polycarbonate Colour: white (RAL 9016)
Installation:	In ceilings with cut-out openings (mounting brackets included). Push-in terminal, 2x2x2.5mm ² Cut out dimensions: Ø68mm
Environment	Indoor
Application	office, education, corridor, public place, showroom, hotel, bathroom, exhibition

ELECTRICAL DATA

Mains voltage:	220-240V, 50/60Hz	System power*, W:	6.5
Power factor:	>0,5	Control gear:	ECG on/off
Integrated sensor:	None	Connection:	Push-in terminal, 2x2x2.5mm ²

LIGHTING DATA

Light source and cap, W:	LED	Light source included:	yes
Luminaire output*, lm(ta+25°C):	550	System efficacy, lm/W:	85
CRI (Ra):	80+	CCT, K:	3000
SDCM:	3	Light Distribution:	Symmetrical medium beam (31...75°)
Distribution Type:	Direct	Beam angle, °:	49
LED lifetime, h:	30000/L70B50		

TECHNICAL DATA

Net weight, kg:	0.13	Mounting holes/cut-out dimensions, mm:	d68
Quantity in package, pcs:	1	Packaging volume, m³/pcs:	0.0005
Pallet quantity, pcs:	1600		
Dimensions, mm:	85x85x44		

STANDARDS

Operating temperature range, °C:	ta -20...+40	Protection class IEC:	II
Ingress protection code:	IP44	Mechanical impact resistance:	IK05
EEC:	F	Certificates:	CE, RoHS
Warranty:	3 years		

Technical drawing (.jpg)

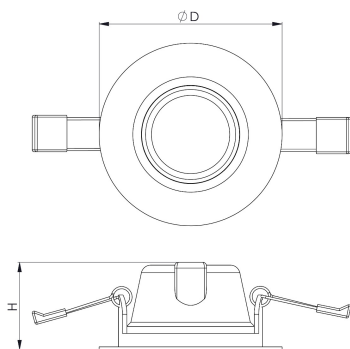

Light distribution curve (.jpg)

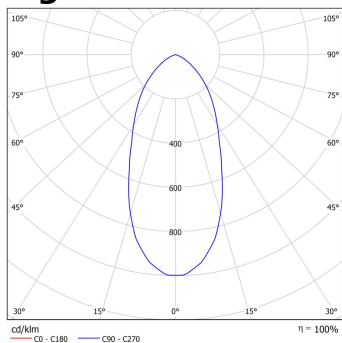

Note:

Tolerance range for optical and electrical data: $\pm 10\%$. Values apply to an ambient temperature of 25°C. NORTHCLIFFE LIGHTING is constantly developing and improving its products. The right is reserved to change any product specifications without prior notification

Date of issue: 2023-05-19 ■ NORTHCLIFFE LIGHTING, UAB ■ Raudondvario pl. 101, LT-47184 Kaunas, Lithuania ■ info@northcliffe.org ■ www.northcliffe.org