

BEGA**88 913**

Swimming pool luminaire

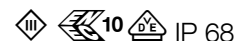

Project · Reference number

Date

Product data sheet

Application

Recessed swimming pool luminaire for the illumination of public and private swimming and bathing pools with drinking water supply.

- Pool with wall tiles
- Pool with film lining
- Metal or synthetic pool

Please note:

The luminaire is intended solely for use under water. Recommended installation depth 400 to 700 mm below the water surface.

The requirements set out in IEC 60364-7-702 (e.g. areas, ambient zones, etc.) are mandatory for the correct installation of the luminaire.

Direct or indirect contact with baser foreign metals via swimming pool water, tools, etc. must be prevented.

For water in swimming pools and bathing pools in accordance with DIN 19643 and typical pool water temperatures (max. 40 °C), the luminaire can be used in water with a chloride ion concentration of up to 500 mg/l.

The swimming pool luminaire is not suitable for brine pools, salt water pools or salt water electrolysis disinfection.

A 24 V safety direct voltage source with a smoothed residual ripple of max. 10 % is required for the operation of the luminaire – see accessories.

Product description

Swimming pool luminaire made of stainless steel – material no. 1.4404 – electropolished
Safety glass, clear
Silicone gasket
Reflector made of pure anodised aluminium
3m Connecting cable 05RN8-F 2 x 1² suitable for laying underwater
Shell colour blue
Installation and luminaire housing with 1 screw cable gland each
Hose connection on installation housing for soft PVC protective hose $\varnothing 20 \times 3$ mm
PVC protective hose for cable routing must be provided by the customer
BEGA article number 62000250
Safety class III

Protection class IP68 10m · Water pressure tight
Maximum submersion depth 10 m
Weight: 1.4 kg
This product contains light sources of energy efficiency class(es) D

Lamp

| | |
|-----------------------------|----------------------------------|
| Module connected wattage | 3.6 W |
| Luminaire connected wattage | 3.9 W |
| Rated temperature | $t_a = 25^\circ\text{C}$ |
| Ambient temperature | $t_{a, \max} = 60^\circ\text{C}$ |
| Voltage | 24 V = DC |

88 913 K3

| | |
|--------------------------------|--------------|
| Module designation | LED-1198/830 |
| Colour temperature | 3000 K |
| Colour rendering index | CRI > 80 |
| Module luminous flux | 585 lm |
| Luminaire luminous flux* | 223 lm |
| Luminaire luminous efficiency* | 57,2 lm/W |

* preliminary data

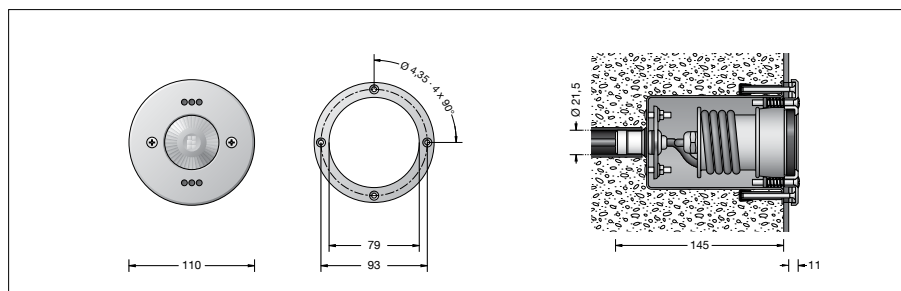

Service life · Ambient temperature

Rated temperature $t_a = 25^\circ\text{C}$
LED module: > 200,000 h (L 80 B 50)
100,000 h (L 90 B 50)

Ambient temperature max. $t_a = 60^\circ\text{C}$ (100 %)
LED module: 150,000 h (L 80 B 50)

Light technique

Installation depth 400 to 700 mm below water level.

In order to achieve uniform luminance distribution for private swimming pools, we recommend an axis distance of 2.00-3.00 m.

Accessories

BEGA Safety transformers according to EN 61558-2-6/VDE 0570, part 2-6

| | |
|---------------|----------------------------------|
| 70 564 | Power supply unit for 5 - 15 W |
| 70 465 | Power supply unit for 10 - 25 W |
| 70 565 | Power supply unit for 20 - 35 W |
| 70 566 | Power supply unit for 30 - 50 W |
| 70 567 | Power supply unit for 40 - 75 W |
| 70 169 | Power supply unit for 70 - 150 W |

70 223 Recessed distribution box for flush installation into floors or in walls. For the installation of cable for the swimming pool luminaire safety class III

For the accessories a separate instructions for use can be provided upon request.